

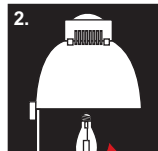
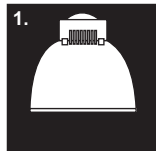


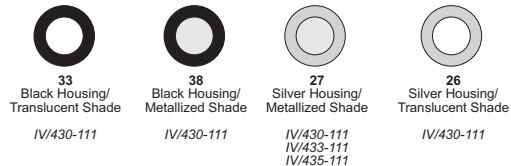
- Commercial pendant
- Gear housing is made in technopolymer with a black or silver paint finish and is complete with gear (fig. 1)
- Reflector is made in polycarbonate and is available with either a translucent or metallised finish (fig. 2)
- Complete with 4mm thick diffuser
- Symmetrical light output
- Includes lamps
- Power cable not supplied
- Utilises new generation compact fluorescent lamps
- Can be installed on normally flammable surfaces
- Class 2
- IP 44

Fig. 1

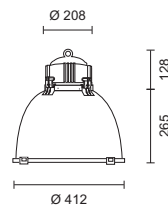
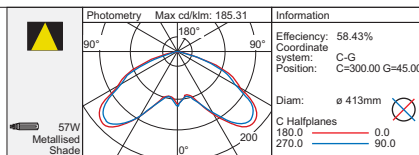


Fig. 2

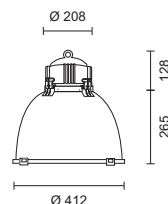
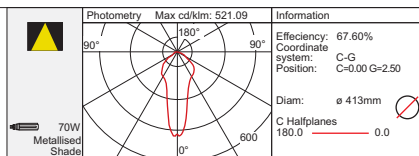




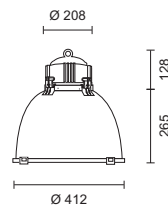
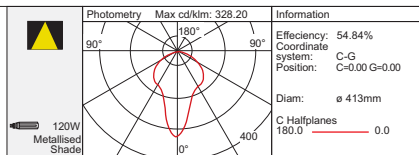
code lamp details  
**57W Compact fluorescent**  
**IV/430-111** 57W 230V GX24q-5  
 Includes integral control gear and lamp



code lamp details  
**70W Compact fluorescent**  
**IV/433-111** 70W 230V GX24q-6  
 Includes integral control gear and lamp



code lamp details  
**120W Compact fluorescent**  
**IV/435-111** 120W 230V 2G8  
 Includes integral control gear and lamp



Power cable not supplied